

# DENON<sup>®</sup>

## AH-C630W

True Wireless In-ear Headphones

# Owner's Manual



## Preparation

<b>Unpacking</b>	<b>4</b>
<b>Part names and functions</b>	<b>5</b>
Earphones	5
Charging case	6
<b>List of operation methods</b>	<b>7</b>
<b>Charge/Power</b>	<b>8</b>
Before charging	8
Charging the charging case	9
Charging the earphones	10
Checking the remaining battery power of the charging case	12
Powering on the earphones	13
Powering off the earphones	13
<b>Wearing</b>	<b>14</b>
Wearing the earphones	14
Replacing the ear tips	15

## Connections

<b>Bluetooth operation</b>	<b>16</b>
Pairing	16
Connecting	16
Connecting to the earphones for the first time	17
Pairing with other Bluetooth devices	19
Changing the Bluetooth device connected to the earphones	22

## Operation

<b>Listening to music</b>	<b>23</b>
Listening to music using a Bluetooth connection	23
Playing in one earphone only	24
<b>Conducting phone calls</b>	<b>25</b>
Making a call	25
Answering an incoming call	26
Ignoring an incoming call	27
Switching the mic on/off (mute)	27
Using the call waiting function	28
<b>Using the voice assistant function (Siri/Google Assistant)</b>	<b>30</b>
<b>Information</b>	<b>31</b>
Audio Playback and Phone Calls on a Bluetooth Device	31



## Troubleshooting

---

<b>Troubleshooting</b>	<b>32</b>
Power does not turn on	32
The earphones/charging case cannot be charged	32
Cannot play media using Bluetooth	33
No sound comes out	34
Cannot hear sound from one earphone	34
Sound is distorted, noisy, or cuts in and out	35
Cannot make a phone call	35
<b>Resetting factory settings</b>	<b>36</b>

## Appendix

---

<b>Precautions for Use</b>	<b>37</b>
<b>Disposal of these earphones</b>	<b>38</b>
<b>Trademark information</b>	<b>38</b>
<b>Specifications</b>	<b>39</b>



Thank you for purchasing this product.

To ensure proper operation, please read this Owner's Manual carefully before using the product.

## Unpacking

Check that all of these are present before using this device.

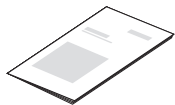

Quick Start Guide

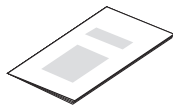

Safety Instructions

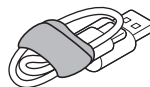

USB cable  
(Type-A to Type-C connector,  
approx. 0.2 m)

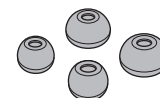

Ear tip (S/L size)



## Part names and functions

### Earphones

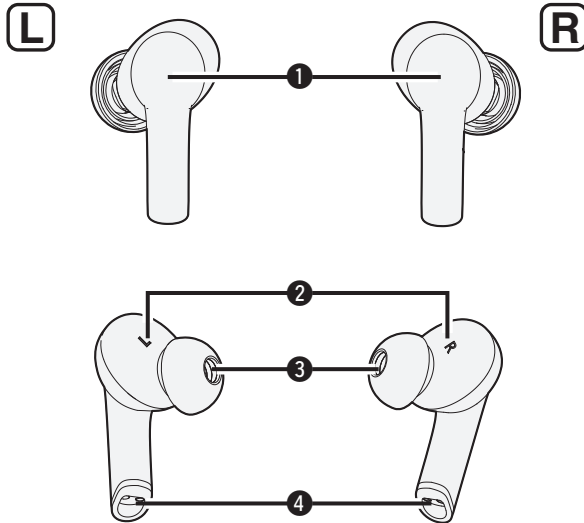

#### 1 Touch sensor

The earphones can be operated by touching them with your finger.

- “Changing the Bluetooth device connected to the earphones” (☞ p. 22)
- “Listening to music” (☞ p. 23)
- “Conducting phone calls” (☞ p. 25)
- “Using the voice assistant function (Siri/Google Assistant)” (☞ p. 30)

#### 2 L/R Indicators

#### 3 Eartip (M size)

#### 4 Charging port

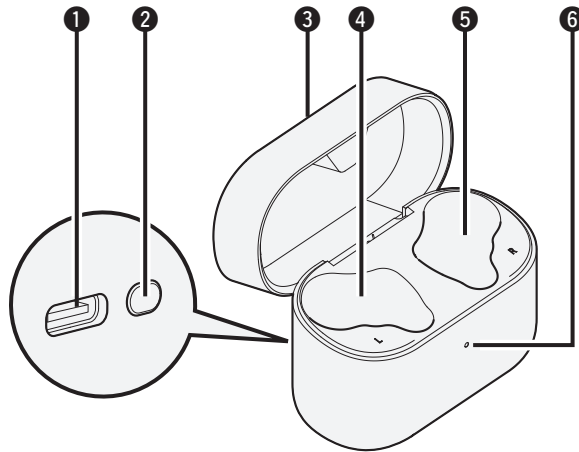

## Charging case

**1 Charging port (USB Type-C)**

Connect the supplied USB cable to charge.

**2 Multi-function button**

Performs various operations.

- “Checking the remaining battery power of the charging case” (👉 p. 12)
- “Pairing with other Bluetooth devices” (👉 p. 19)
- “Resetting factory settings” (👉 p. 36)

**3 Lid**

By opening and closing the lid, it turns on and off the earphones, charges them, and displays the remaining battery power of the charging case.

- “Charge/Power” (👉 p. 8)

**4 Left earphone charging unit****5 Right earphone charging unit****6 Status LED**

Displays various statuses such as the charge status, rechargeable battery level, and Bluetooth connection status.



# List of operation methods

The main operation methods of the earphones are as follows.

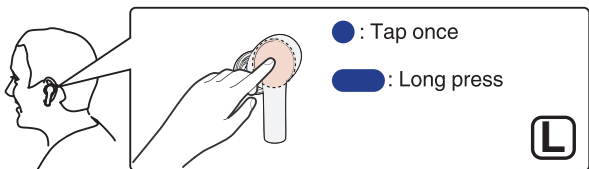
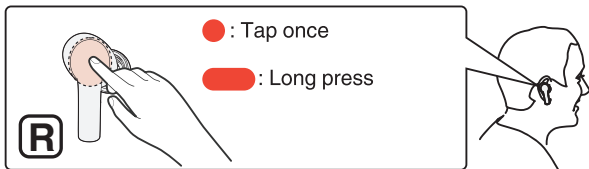

Music control	Play/Pause	●
	Next track	● ●
	Previous track	● ● ●
Call operation	Answer the call	● ● or ● ●
	Hang up the call	● ● or ● ●
	Ignore the call	● ■ 2s or ● ■ 2s
	Mute/Unmute mic (Call is active, no second call)	● ■ 5s or ● ■ 5s
Voice assistant	Enter/Cancel Siri or Google Assistant	● ■ 3s
Pairing	Enter Bluetooth pairing mode	● ■ 5s



# Charge/Power

A rechargeable battery is built into the earphones and charging case. Use the supplied USB cable to connect to the computer or a USB AC adapter (commercially available) for charging.

## Before charging

### 1 Remove the power supply prevention film from the earphones.

- Do this when using for the first time.

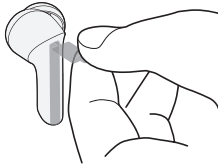

### 2 Put the earphones in the charging case (supplied).

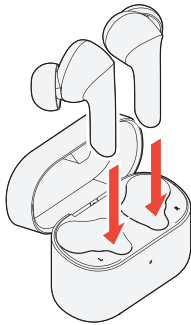

### 3 Close the lid of the charging case.

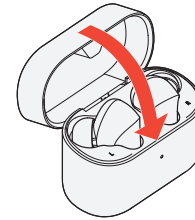



## Charging the charging case

If the charging case is charged with the earphones in it, both the charging case and earphones are charged.

### 1 Connect the charging case to the USB AC adapter (commercially available) or a PC with the USB cable (supplied).

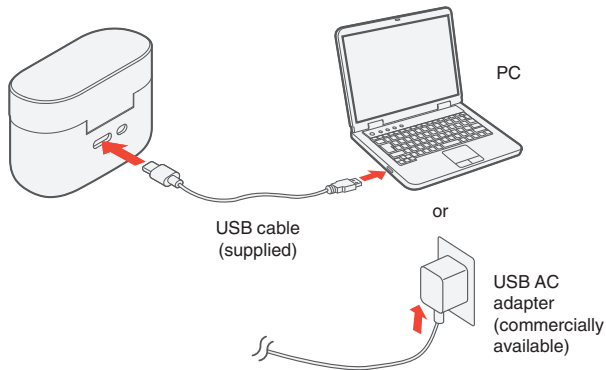

The charging status can be checked from the status LED on the charging case.

Charging status	Color of status LED	
Charging (20 % or less)	Blinks in red	
Charging (more than 20 %)	Blinks in green	
Fully charged	Solid green	



- When using the earphones for the first time after purchase or when the remaining power of the rechargeable battery is low, charge the battery. When the level of the rechargeable battery is low, a notification sound is heard from the earphones.
- The earphones can be used for approximately 4.5 hours of music playback when fully charged.
- It takes approximately 2 hours to fully charge the rechargeable battery from the state of no remaining battery power.
- The usable time of the earphones differs depending on the temperature of the environment in which they are used and method of use.



**NOTE**

- When connecting the USB cable to the USB port, be sure to match the cable connector with the shape of the socket. Forcing the connector into the socket will cause damage.
- The rating of the charging output should be DC 5 V, 2.4 A or less.
- If the charging ports of the earphones and charging case are dirty, charging may not be possible. Wrap a clean cloth soaked with anhydrous ethanol around a toothpick and gently wipe the ports regularly.
- If the earphones get any moisture, thoroughly wipe it off before inserting them in the charging case.
- When you are charging your earphones by connecting them to your computer, even if the computer displays an error message indicating that the USB device is not recognized, they will be charged. For the charge state, check the status LED.

## Charging the earphones

The earphones are charged from the charging case simply by inserting them in the charged charging case. Even if there is no access to power when on the go, the earphones can be charged.

### 1 Insert the earphones in the charged charging case.

- If you open the lid of the charging case, the status LED displays the amount of charge remaining in the charging case.  
(☞ p. 12)

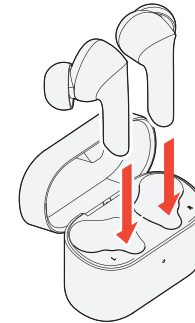

## 2 Close the lid of the charging case.

Charging begins.

- If you close the lid of the charging case, the status LED displays the amount of charge remaining in the charging case.  
( p. 12)

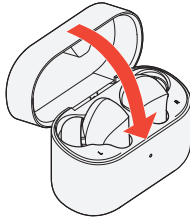

- A fully charged charging case can fully recharge earphones that have zero remaining charge three times.
- It takes approximately 2 hours to fully charge the rechargeable battery from the state of no remaining battery power.
- When the rechargeable battery built into the earphones is low, a notification sounds. Charge the earphones.
- Even if you insert only one earphone into the charging case, it can be charged.



### NOTE

- If the charging ports of the earphones and charging case are dirty, charging may not be possible. Wrap a clean cloth soaked with anhydrous ethanol around a toothpick and gently wipe the ports regularly.
- If the earphones get any moisture, thoroughly wipe it off before inserting them in the charging case.
- Check the remaining battery power of the earphones on the screen of the connected Bluetooth device.



## Checking the remaining battery power of the charging case

If you open or close the lid of the charging case, the status LED displays the rechargeable battery level of the charging case as shown below.

Remaining battery power	Color of status LED	
20 % or less	Lights up red	
More than 20 %	Lights up green	



- The rechargeable battery level of the charging case can also be checked by pressing the multi-function button.



## Powering on the earphones

### 1 With the earphones in the charging case, open the lid of the charging case.

The earphones are automatically turned on and started the Bluetooth connection.

- When connecting to a Bluetooth device for the first time, the earphones are in the pairing mode after the power is turned on. Make the Bluetooth connection. (👉 p. 17)

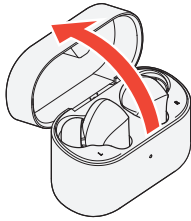

## Powering off the earphones

### 1 With the earphones in the charging case, close the lid of the charging case.

The earphones are turned off and charging begins. (👉 p. 10)

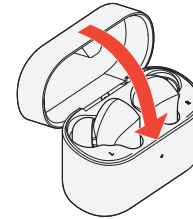

# Wearing

## Wearing the earphones

### 1 Put the earphones in your ears.

- Put the earphone marked with L (left) in your left ear and the one marked with R (right) in your right ear.

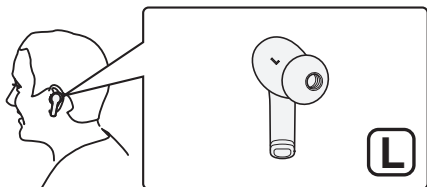
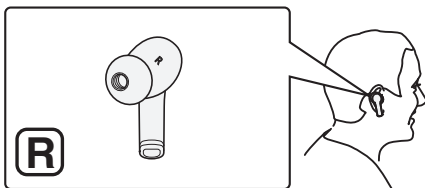

#### NOTE

- Different ear tip sizes are included. If the ear tips do not fit your ear, replace them with an appropriate size. (🔧 p. 15)
- If you accidentally touch the touch sensors while wearing the earphones, they will activate. Be careful not to accidentally touch the touch sensors.



## Replacing the ear tips

When purchased, the M size ear tips are attached to the earphones. If they do not fit well in your ears due to the size of the ear tips, replace them with the supplied ear tips (S/L sizes).

### NOTE

- If you use ear tips other than those included, the earphones may not fit into the charging case, or may not charge. Be sure to use the included ear tips.

### 1 Remove the ear tips.

- Hold the ear tip and pull while tilting it.

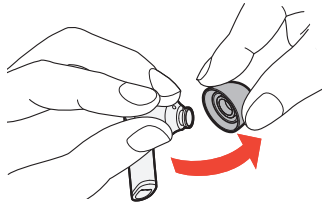

### 2 Attach the ear tips.

- Align the nozzle with the ear tip attachment part and push it all the way in using a small amount of force.

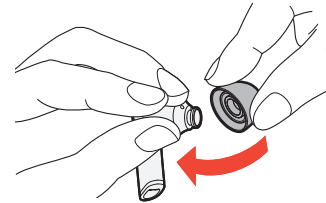

# Bluetooth operation

You can enjoy listening to music wirelessly by connecting the earphones to your Bluetooth device.

## Pairing

Pairing (registration) is an operation that is required in order to connect a Bluetooth device to the earphones. When using Bluetooth for the first time, you need to pair the earphones and your Bluetooth device so they can communicate with each other. Once a Bluetooth device has been paired with your earphones, pairing does not need to be performed again for future Bluetooth connections with that device.



- Pairing needs to be done again in the following cases.
  - When 9 or more devices have been paired with the earphones  
These earphones can store pairing information from a maximum of 8 devices.  
When 9 or more devices are paired, the new pairing information overwrites the oldest pairing information in order from the oldest information onwards.
- Multiple Bluetooth devices cannot be played back at the same time.

## Connecting

There are three methods for connecting with Bluetooth devices:

**1**

**Connecting to the earphones for the first time**  
(👉 p. 17)

**2**

**Pairing with other Bluetooth devices**  
(👉 p. 19)

**3**

**Changing the Bluetooth device connected to the earphones** (👉 p. 22)





## Connecting to the earphones for the first time

### 1 With the earphones in the charging case, open the lid of the charging case.

The pairing mode will be activated.

- During the pairing mode, the status LED flashes slowly in white.

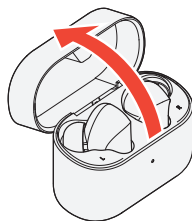

### 2 Turn on the Bluetooth function of your Bluetooth device.

- For details, see the Owner's Manual of the Bluetooth device that you want to connect.

### 3 Select "DENON AH-C630W" from the list of devices displayed on the screen of your Bluetooth device.

The Bluetooth connection is established.

- On the screen of the Bluetooth device, confirm that a connection has been made.

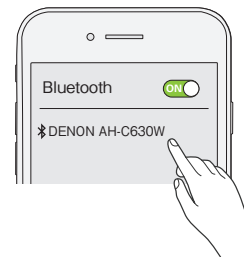

## 4 Playing back music on the Bluetooth device.

Music played back on the connected Bluetooth device is output from the earphones.

### NOTE

- Before playing music, check the volume setting of the used Bluetooth device and enjoy it at the appropriate volume. Volume operation cannot be performed with the earphones.
- If you put the earphones in the charging case and open the lid of the charging case again, earphones automatically connects to the last Bluetooth device that was connected.



- The earphones pairing mode is canceled if pairing is not completed within 2 minutes. In this case, if the lid of the charging case is opened after closing it, the earphones perform a pairing again.
- If the status LED does not flash in white even when you open the lid of the charging case, the earphones are not in the pairing mode. With the lid of the charging case left open, long press the multi-function button on the back of the charging case for approximately 2 seconds to switch to the pairing mode.

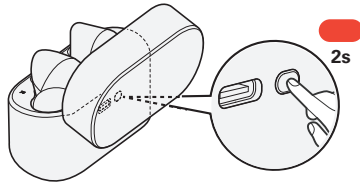

- If you are requested to enter a PIN code (pass key), enter "0000" (four zeros).



## Pairing with other Bluetooth devices

To pair the earphones to two or more Bluetooth devices, you must manually change the earphones to the pairing mode. There are two ways to manually change the earphones to the pairing mode, from the charging case and from the earphones.

### ■ Operating the charging case

#### 1 Insert the earphones in the case.

- Do not close the lid of the charging case.

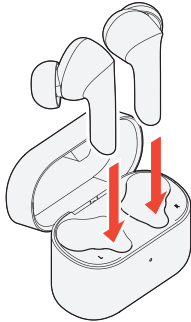

#### 2 With the lid of the charging case open, long press the multi-function button for approximately 2 seconds.

If the LED on the charging case is slowly flashing in white, the earphones are in the pairing mode.

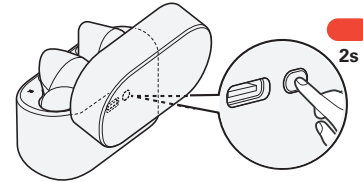

### 3 Turn on the Bluetooth function of your Bluetooth device.

- For details, see the Owner's Manual of the Bluetooth device that you want to connect.

### 4 Select "DENON AH-C630W" from the list of devices displayed on the screen of the Bluetooth device.

The Bluetooth connection is established.

- On the screen of the Bluetooth device, confirm that a connection has been made.



## ■ Operating the earphones

### 1 Tap the touch sensor of the left earphone, and then press again for approximately 5 seconds.

The pairing mode will be activated with a notification sound from the earphones.

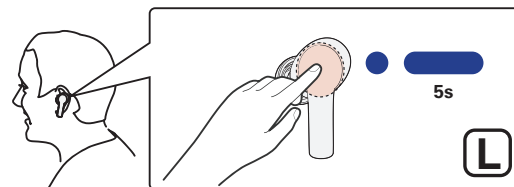

## 2 Turn on the Bluetooth function of your Bluetooth device.

- For details, see the Owner's Manual of the Bluetooth device that you want to connect.

## 3 Select "DENON AH-C630W" from the list of devices displayed on the screen of the Bluetooth device.

The Bluetooth connection is established.

- On the screen of the Bluetooth device, confirm that a connection has been made.



## Changing the Bluetooth device connected to the earphones

Disconnect the earphones from the connected Bluetooth device and switch the connection to another Bluetooth device. When you are connecting to a previously paired device, the earphones can be connected by operating the Bluetooth device.

- 1 From the currently connected Bluetooth device, disconnect the earphones.**
- 2 Turn on the Bluetooth function of the Bluetooth device you want to connect to.**
  - For details, see the Owner's Manual of the Bluetooth device that you want to connect.

- 3 From the list of devices displayed on the Bluetooth device you want to connect to, choose "DENON AH-C630W".**

The Bluetooth connection is established.

- On the screen of the Bluetooth device, confirm that a connection has been made.

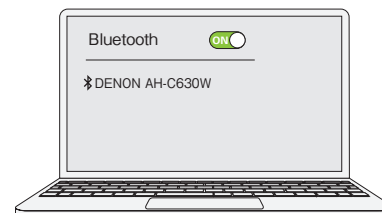

- If the earphones cannot be connected, tap the touch sensor of the left earphone, and then press again for approximately 5 seconds to put the earphones into pairing mode. During the pairing mode, perform steps 2 to 3 again.

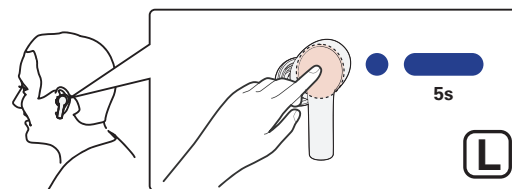

# Listening to music

## Listening to music using a Bluetooth connection

First check that the earphones and Bluetooth device are connected via Bluetooth. (👉 p. 16)

Playback operations can be performed from both the Bluetooth device and earphones. Here we will explain the operations using the earphones.

### NOTE

- Before playing music, check the volume setting of the used Bluetooth device and enjoy it at the appropriate volume. Volume operation cannot be performed with the earphones.

### Playback/pause

Tap the touch sensor of the right earphone once.

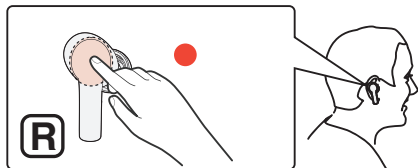

### Select track

Next track: Tap the touch sensor of the right earphone twice.

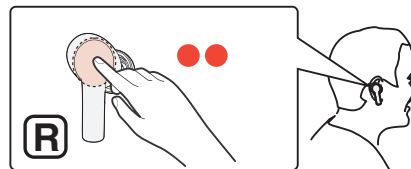

Previous track: Tap the touch sensor of the right earphone 3 times.

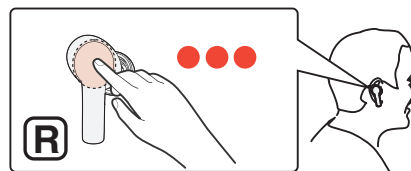

- You can also wear just a single earphone on one side.
- If one of the earphones is out of charge, you can continue playback with the other earphone only. In this case, playback is in monaural sound.



## Playing in one earphone only

The earphones can be used on one side only. If stereo sound is played on one side only, the sound is automatically converted to play monaural sound.

### 1 Wear the earphone you want to use.

- Place the unused earphone in the charging case.

#### NOTE

- When you place the right earphone in the charging case, you can perform playback operation from the left earphone. (☞ p. 23)

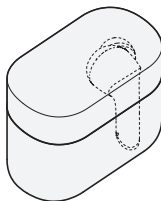



# Conducting phone calls

Calls can be made while you are wearing the earphones. You can hear the caller's voice through the earphones, and your voice is picked up by the built-in microphone in the earphones. Bluetooth supported mobile phones that are connected can be operated with the touch sensor on the right or left earphone.

## Making a call

### 1 Calls can be made by operating your currently used mobile phone.

Music playback is paused and the call is connected.

#### NOTE

- Adjust the volume from the mobile phone.
- While the dial tone can be heard, double tap the touch sensor on the right or left earphone to cancel the call.

### 2 To finish a call, double tap the touch sensor on the right or left earphone.

When a call is hunged up, playback of the paused track is restarted.

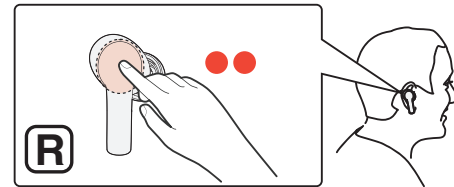

or

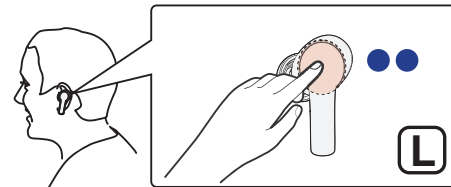

## Answering an incoming call

- 1** If you receive an incoming call, double tap the touch sensor on the right or left earphone to answer the call. Music playback is paused and the call is connected.

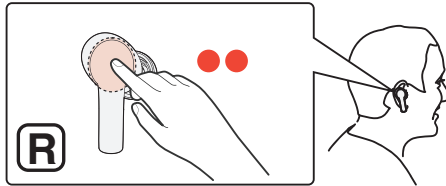

or

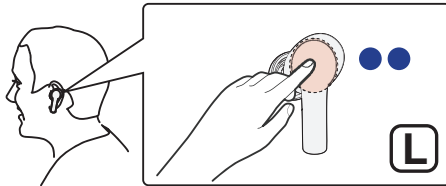

- 2** To finish a call, double tap the touch sensor on the right or left earphone.

When a call is hanged up, playback of the paused track is restarted.

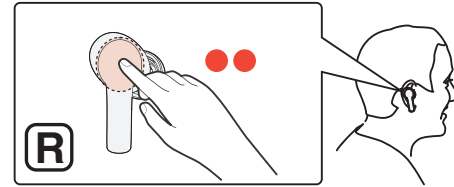

or

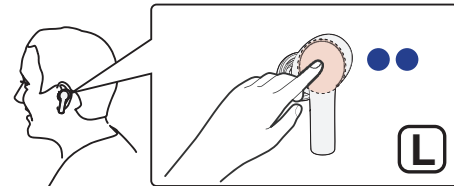

### NOTE

- Adjust the volume from the mobile phone.



## Ignoring an incoming call

- 1 If you receive an incoming call, tapping the touch sensor on the right or left earphone, and then press again for approximately 2 seconds.

The phone will hang up.

- When a call is hanged up, playback of the paused track is restarted.

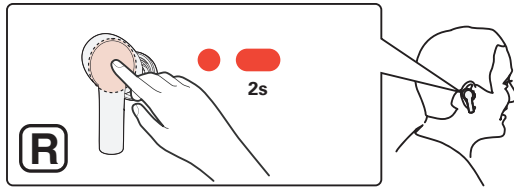

or

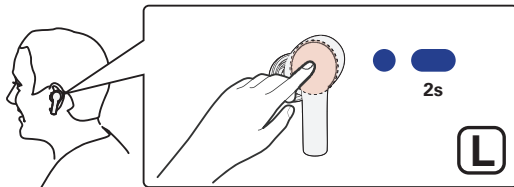

## Switching the mic on/off (mute)

- 1 During a call, tap the touch sensor of the right or left earphone, and then press again for approximately 5 seconds.

Each you operate it and the mode of the mic switches on/off (mute) with a notification sound from the earphones.

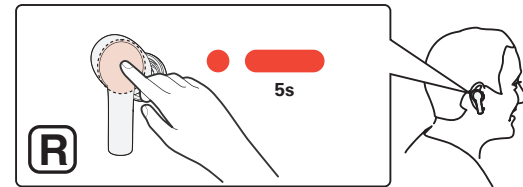

or

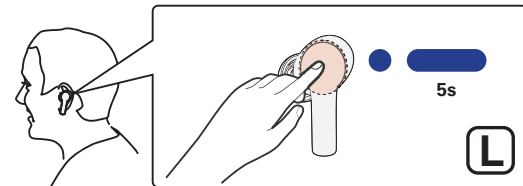

## Using the call waiting function

If you receive a call while another call is already in progress, you can place the current call (call A) on hold and switch to the new call (call B).



- Some of mobile phones may not be compatible with these functions.

### 1 If you receive a call while on a call, double tap the touch sensor on the right or left earphone.

- This places the current call (call A) on hold and switches to the new call (call B).
- When the new call (call B) ends, the earphones return to the call that is on hold (call A).

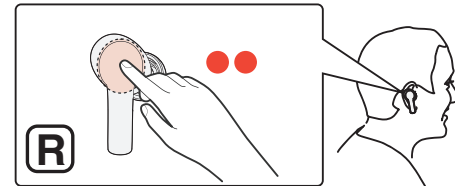

or

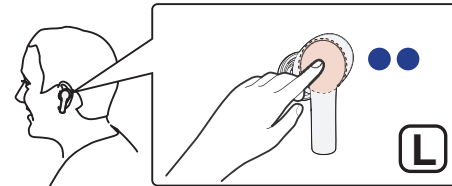

- If you long press the touch sensor on the right or left earphone for approximately 2 seconds while receiving a call, you can reject the call.



## ■ To return to the call that is on hold (call A)

### 1 Double tap the touch sensor on the right or left earphone during a call (call B).

- This ends the current call (call B) and resumes the call that is on hold (call A).

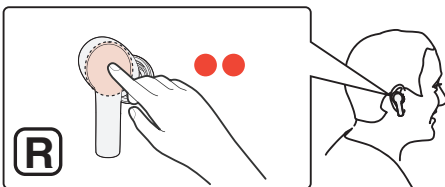

or

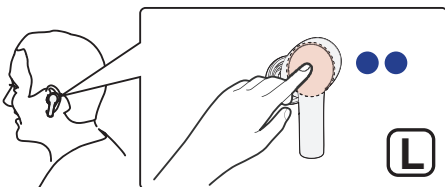

## Using the voice assistant function (Siri/Google Assistant)

The voice assistant function (Siri/Google Assistant) built-in devices can be started and can be used to operate devices by voice from the mic of the earphones.

- 1 Connect to devices via Bluetooth. (📖 p. 16)**
- 2 Tap the touch sensor of the right earphone, and then press again for approximately 3 seconds.**

The voice assistant function is started.

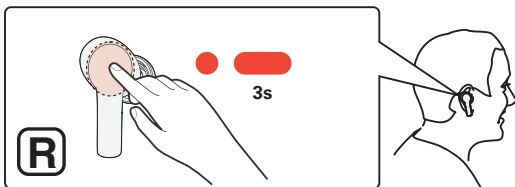

- To close the voice assistant function, tap the touch sensor of the right earphone again and then long press for approximately 3 seconds.



## Information

---

### Audio Playback and Phone Calls on a Bluetooth Device

- These earphones are compatible with SCMS-T content security standards. You can use these earphones with SCMS-T compatible mobile phones or devices.
  - In order to listen to music via a Bluetooth connection, the connected Bluetooth device needs to be A2DP (Advanced Audio Distribution Profile) compatible. (\*)
  - In order to control playback of the Bluetooth device using the earphones, the connected Bluetooth device needs to be AVRCP (Audio Video Remote Control Profile) compatible. (\*)
  - The connected Bluetooth device needs to be compatible with either HSP (Headset Profile) or HFP (Hands-free Profile) in order to use the earphones for conducting phone calls. (\*)
  - The Bluetooth device needs to be compatible with either HFP or HSP and A2DP in order to conduct calls during audio playback. (\*)
- \* For details on profiles that the Bluetooth device is compatible with, see the Bluetooth device Owner's Manual.



# Troubleshooting

First, check the following.

1. Are all of the connections correct?
2. Were the instructions in the manual followed correctly?
3. Is the connected device being operated correctly?

If the earphones do not operate properly, check the corresponding issue here.

If the issue is not covered here, there may be a malfunction. Contact the store where you purchased the earphones. If the staff at the store where you purchased the earphones also do not know how to resolve the issue, contact the Denon Customer Service Center or your nearest Repairs Center.

## Power does not turn on

### Power does not turn on.

- When the rechargeable battery has no power remaining, put the earphones in the charging case and connect the charging case to an AC adapter or computer using the supplied USB cable to charge the battery. (🔗 p. 9)

## The earphones/charging case cannot be charged

### The earphones cannot be charged.

- Remove the power supply prevention film from the earphones. (Do this when using for the first time) (🔗 p. 8)
- Make sure the charging case is charged in advance.
- Wrap a clean cloth soaked with anhydrous ethanol around a toothpick and gently clean the dirt stuck to the ports on the earphones and charging case.

### The charging case cannot be charged.

- Make sure the supplied USB cable is connected correctly from the charging case to a USB AC adapter or a computer.
- If the charging case are connected to the computer via the USB port, check that the computer is powered on.





## Cannot play media using Bluetooth

### Cannot connect using Bluetooth.

- Check that the power of the Bluetooth device is on and the Bluetooth function is enabled.
- Check whether the Bluetooth device is in sleep status.
- Bring the earphones and the Bluetooth device closer together.
- Turn the Bluetooth device off and back on and try again.
- If the status LED does not flash in white even when you open the lid of the charging case, the earphones are not in the pairing mode. With the lid of the charging case left open, long press the multi-function button on the back of the charging case for approximately 2 seconds to switch to the pairing mode.
- Select A2DP as the Bluetooth connection profile on the transmitting Bluetooth device. For details, see the Owner's Manual of the Bluetooth device.

### Sound is not output from the earphones when connected using Bluetooth.

- Check that audio is being played back on the Bluetooth device.
- Volume operation cannot be performed with the earphones. Raise the volume on the Bluetooth device side.
- Make sure the earphones are not connected to another Bluetooth device. If they are connected, switch the connection to the Bluetooth device you want to use. (🔗 p. 22)



## No sound comes out

### No sound comes out.

- Pair the earphones with the Bluetooth device. (👉 p. 16)
- Check that the connected device are powered on.
- Adjust the volume of the connected device to a suitable level.

## Cannot hear sound from one earphone

### Cannot hear sound from one earphone.

- The left and right earphones are charged independently from the other. Depending on how you use your earphones, battery consumption differs in the left and right earphones. Therefore, the amount of charge remaining in one of earphones may run out before the other. Put the earphones in the charging case and connect the charging case to an AC adapter or computer using the supplied USB cable to charge the battery. (👉 p. 9)
- The pairing between the left and right earphones has been cancelled. Insert the earphones in the charging case and pair the left and right earphones by pressing the multi-function button on the charging case twice while the lid is open.



## Sound is distorted, noisy, or cuts in and out

### Sound is distorted, noisy, or cuts in and out.

- Adjust the volume of the connected device to a suitable level.
- The Bluetooth device is out of range. Bring the Bluetooth device closer to the earphones.
- The Bluetooth connection is experiencing wireless interference. Move the earphones away from appliances such as microwave ovens and other wireless devices.
- Power cycle the device and try again.

## Cannot make a phone call

### Cannot make a phone call.

- Some smartphones and phone apps do not support hands-free calls.

### Cannot hear the caller's voice.

- When there is an incoming call, double tap the touch sensor on the right or left earphone to answer the call.
- Check that the power of the Bluetooth device is on and the Bluetooth function is enabled.
- Select HSP or HFP as the Bluetooth connection profile on the transmitting Bluetooth device. For details, see the Owner's Manual of the Bluetooth device.
- Check that the Bluetooth device is set to handle calls through the earphones. For details, see the Owner's Manual of the Bluetooth device.
- Raise the earphones volume on the Bluetooth device side. Volume operation cannot be performed with the earphones.

### Your voice cannot be heard by the other party.

- If the built-in mic function is off (mute), your voice is muted. Turn on the mic function. (📖 p. 27)



## Resetting factory settings

If the earphones are not working properly, reset them.

The various settings are reset to the factory default. Configure the settings again.

### 1 Insert the earphones in the charging case.

- Do not close the lid of the charging case.

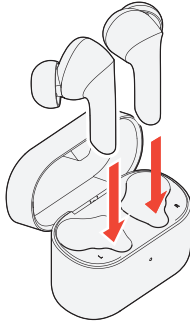

### 2 With the lid of the charging case left open, long press the multi-function button for approximately 10 seconds.

After the status LED blinks for 3 seconds alternating between red and green.

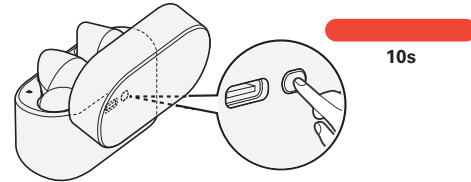

### 3 Close the lid of the charging case.

All the settings are reset to the factory default.

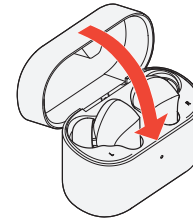

## Precautions for Use

---

- Be sure to read the Owner's Manual of the device that you want to connect.
- Check the volume settings when using the earphones on public transport or in public places and make sure you do not disturb people around you.
- These earphones are not guaranteed to work with all combinations of Bluetooth devices/mobile phones.
- These earphones do not support connection with all Bluetooth devices/mobile phones.
- Bluetooth wireless technology can communicate over a distance of approximately 10 m. However, obstructions (people, metallic objects, walls, etc.) and radio wave conditions affect the range in which communication is possible.
- The Bluetooth device that you want to connect must support the same profile as these earphones in order to use the Bluetooth function. For details on profiles that the Bluetooth device is compatible with, see the Bluetooth device Owner's Manual.
- Due to features of Bluetooth wireless technology, playback of audio on the earphones is slightly delayed compared to the voice/audio playback on the transmitting device.



## Disposal of these earphones

---

The rechargeable battery built into these earphones can be recycled. Contact the Denon Customer Service Center for details on disposing of these earphones.

## Trademark information

---



The Bluetooth® word mark and logos are registered trademarks owned by the Bluetooth SIG, Inc. and any use of such marks by D&M Holdings Inc. is under license. Other trademarks and trade names are those of their respective owners.



# Specifications

---

## ■ Earphone section

Type:	Dynamic type
Drive units:	φ10 mm
Playback frequency:	20 – 20,000 Hz

## ■ Bluetooth section

Compatible standards:	Bluetooth 5.0
Transmission power class:	Class1
Compatible profiles:	A2DP/AVRCP/HSP/HFP
A2DP codec support:	AAC/SBC
Continuous playback time:	Approx. 4.5 hours Approx. 18 hours (with 3 × recharge via the changing case)



## ■ General

<b>Operating temperature range:</b>	5 °C - 40 °C
<b>Rating of the charging input to the charging case:</b>	DC 5 V, 2.4 A or less
<b>Power supply:</b>	DC 3.8 V (internal lithium polymer rechargeable battery for earphones) DC 3.7 V (internal lithium polymer rechargeable battery for charging case)
<b>Weight:</b>	4.7 g×2 (earphones) 43 g (charging case)

\* For purposes of improvement, specifications and design are subject to change without notice.





**DENON®**

[www.denon.com](http://www.denon.com)

3520 10822 00AD

© 2021 Sound United. All Rights Reserved.